

Martin® Manufactured Canoe Liners



Installed inside conveyor transfer point skirtboards, [Martin® Manufactured Canoe Liners](#) absorb impact and abrasion and creates a dam to shield the sealing system from the weight of the material load, prolonging the life of the seal.

The Martin Manufactured Canoe Liners feature a steel plate molded inside the urethane to prevent bond issues. Liners are also stackable to line higher drop chutes.

NOMENCLATURE

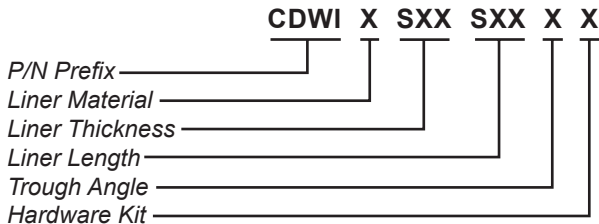

LINER MATERIAL

U: Urethane

LINER THICKNESS

13: 1.3 inches

20: 2.0 inches

LINER LENGTH

48: 48 inches

TROUGH ANGLE

2: 20 degree

3: 35 degree

4: 45 degree

HARDWARE KIT

0: Without Hardware

K: With Hardware

DIMENSIONS — IN. (MM)

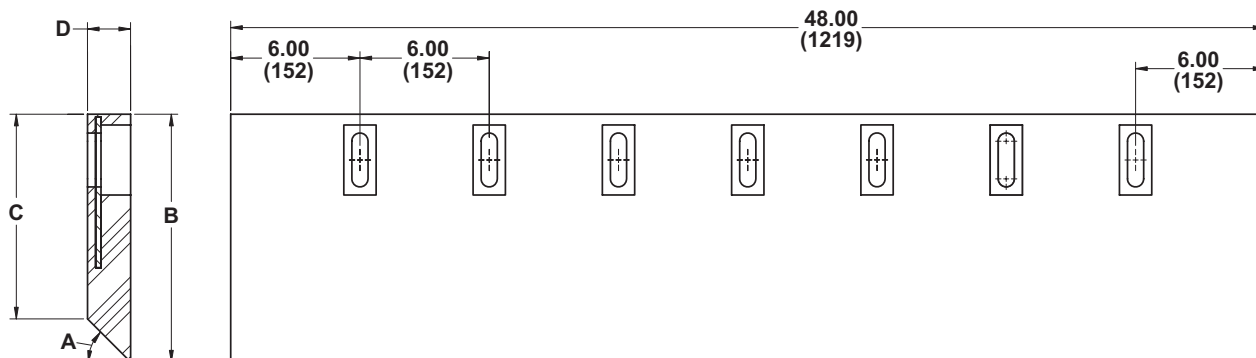

Dim. A Trough Angle	Dim. B in. (mm)		Dim. C in. (mm)		Dim. D in. (mm)	
	CDWIUS13S48X0	CDWIUS20S48X0	CDWIUS13S48X0	CDWIUS20S48X0	CDWIUS13S48X0	CDWIUS20S48X0
20 Degrees	6.75 (172)	9.88 (251)	6.30 (160)	9.15 (233)	1.25 (32)	2.00 (51)
35 Degrees		10.75 (273)	5.87 (149)	9.35 (238)		
45 Degrees		11.50 (292)	5.50 (140)	9.50 (241)		



Martin Engineering USA
 One Martin Place
 Neponset, IL 61345-9766 USA
 800 544 2947 or 309 852 2384
 Fax 800 814 1553
www.martin-eng.com

**COMPANY WITH
 QUALITY SYSTEM
 CERTIFIED BY DNV GL
 = ISO 9001 =**